

⊕ SELECT DESIRED HEIGHT

- WP52F ~ 60"
- WP62F ~ 72"
- WP72F ~ 84"
- WP82F ~ 96"

⊕ SELECT DESIRED PAD COLOR (<https://www.bisoninc.com/color-options/>):

- SPECIFY COLOR: _____

⊕ SELECT STANDARD INDOOR WALL PADDING UPGRADE OPTIONS

- 3" FOAM INDOOR WALL PADDING (WP1443IN)
- FLAME GUARD FIRE RETARDANT COATING FOR WALL PADDING (WP144CFR)
MEETS: CLASS A, ASTM E2768, NFPA 255 703, ANSI/UL 723 & UBC 42.1
- 2" HIGH DENSITY FOAM (WP144HD)
- 3" "SAF-GUARD" NEOPRENE FOAM (WP144NFR)
MEETS: ASTM D3675, ASTM E662, ASTM E1354, FMVSS 302,
14CFR 25.853(a) & CALIFORNIA T.B. No. 133
- "VONAR" INTERLINING (WP144VFR)

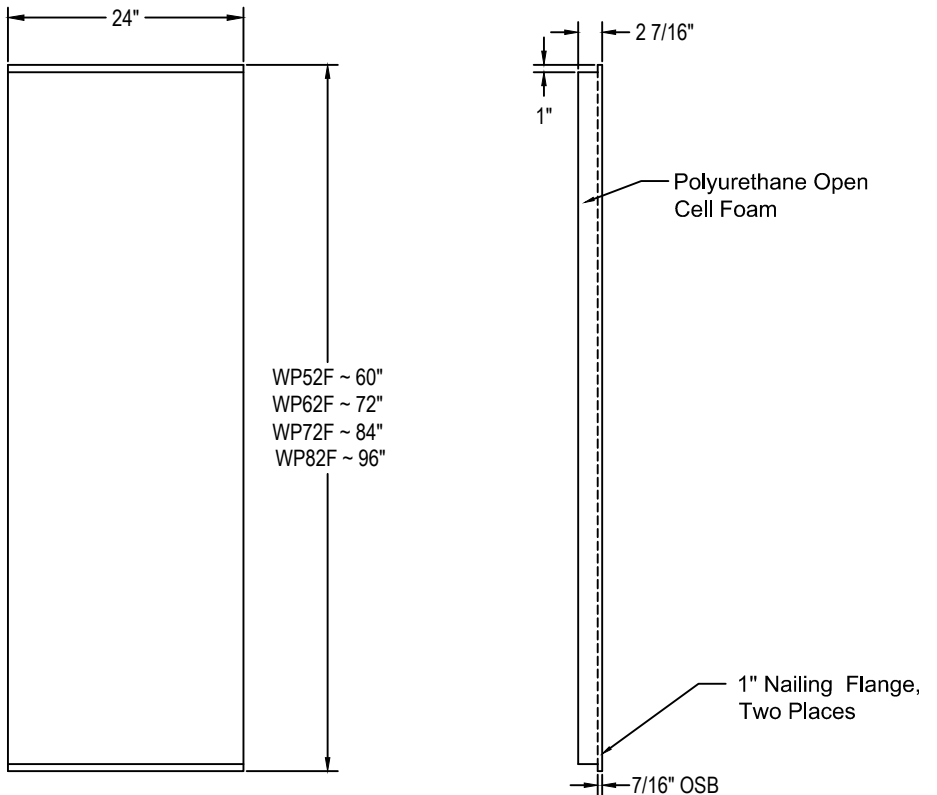

Wall padding shall be constructed of 7/16" OSB oriented strand board with 2" thick polyurethane open cell foam attached by means of non-flammable adhesive. Foam shall conform to ASTM G21 for antimicrobial resistance and conform to 16CFR 1632, California TIB 117 A&D and D.O.T. FMVSS 302 for fire combustibility. Padding shall be covered with 14 oz. per square yard leather grain embossed vinyl coated polyester fabric. Vinyl cover shall meet or exceed NFPA-701, CSFM and ASTM E-84 Class A fire retardant ratings and be treated for mildew and UV resistance. Coated vinyl fabric should have a minimum 350 PSI tensile strength and an 85# tear strength. Fabric shall be attached to the OSB with staples no less than 2" apart. Padding shall be mounted to the wall by the flange nailers at top and bottom of each section. Specify vinyl colors and panel sizes. Approximate weight 2 1/5#, 2" per square foot. Installation to be completed in accordance with manufacturer's instructions. Do not scale drawings.



PRODUCT SPECIFICATION

2' WIDE, SOLID COLOR FLANGE MOUNT WALL PADDING

REVISED 8/1/17